



HERO SAFEGUARD

Application Guide

Preparing the Area & Equipment

Hero Flooring recommends using a microfiber mop designed for coating application. It is also recommended to line the mop bucket with a garbage bag, this will keep the Safeguard from entering the mop bucket and eliminate the possibility of a foreign substance or unwanted chemical from getting into the coating or on the floor. It will also eliminate another clean up step once you have finished applying the Safeguard. Set up all necessary caution/wet floor/ restroom closed floor signs. Isolate or close off any area that will have Safeguard applied to it. You cannot have any traffic through this area until all coats are completely dried. Ensure the rubber flooring is completely dried (including pores) before applying the initial coat of Safeguard. If the floor is not 100% dry, Safeguard will not set or cure properly.

Applying the First Coat

Calculate the amount of square footage that needs to be coated. Always ensure to have more Safeguard on hand than is necessary. You do not want to run out before the job is finished. Safeguard will cover approximately 1000-1200 square feet per gallon on the first coat and 1200-1400 on subsequent applications.

Using a microfiber mop, simply pour Safeguard into a bucket, and slightly wringing it out, so the mop is damp, fully saturated, but not dripping. Apply a thin coat of Safeguard to the floor starting at the entranceway and outline the room, running along the baseboards. You will then do a 180° turn back to the third wall, and fill in the rest of the area by working a back and fourth pattern until you work your way out the door (see image on page 2). This is not only providing complete coverage, but it is the most efficient way to apply a coating in a room without ever doubling up and walking over an area you've already completed. If any coating is splashed onto the baseboards or surrounding objects, it should be removed immediately as removal later can be a lengthy and tedious process. The first coat must be allowed to completely dry before applying subsequent coats. Allow a minimum of 1-hour dry time if you are planning on applying subsequent coats of Safeguard. Dry time will vary with humidity, temperature and ventilation. Adjust accordingly. One coat of Safeguard is typically adequate to blend in shade variation or the natural tendency of framing. Subsequent coats may be desired to enhance cleaning and maintenance efforts.

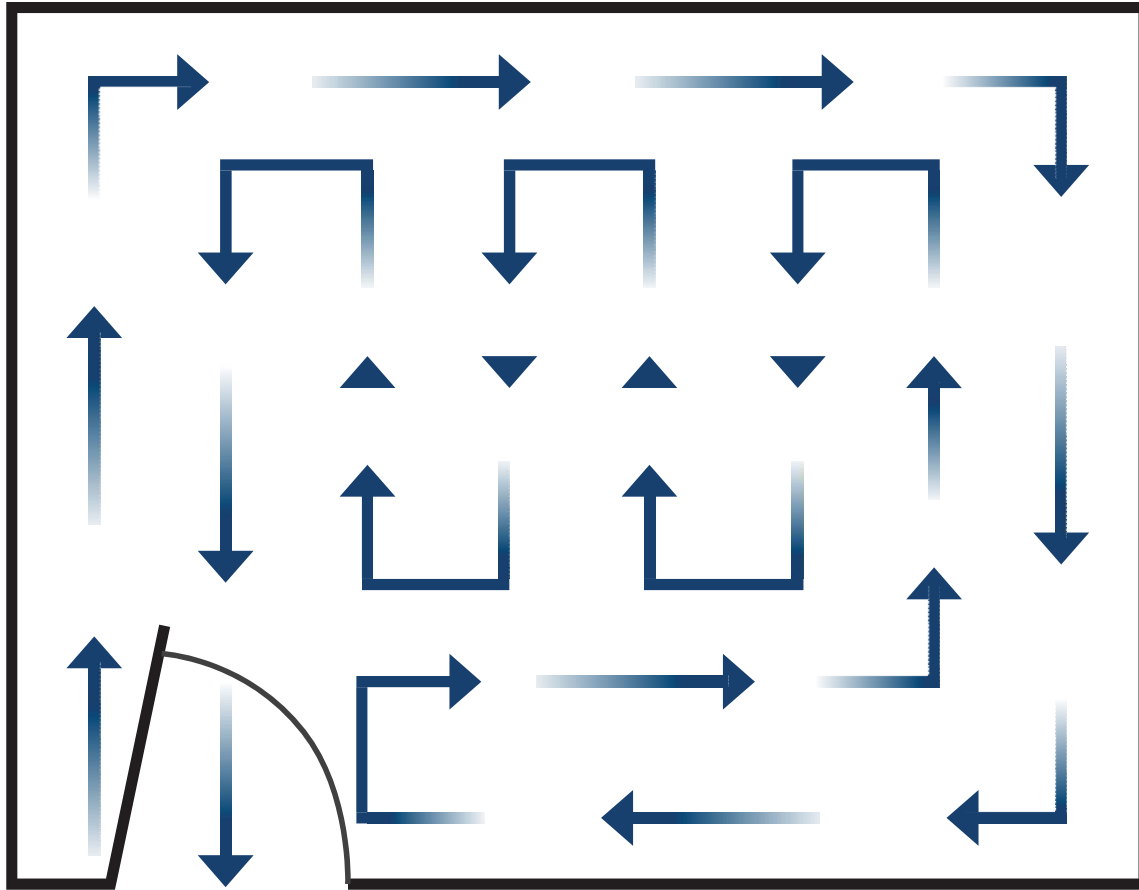

Clean-Up

If there are several areas that need coating over the next few days, you can tie off the mop inside a garbage bag. This will create a sealed environment so the mop will stay damp and not dry out. If you are finished applying Safeguard rinse the mop for a few minutes until all the coating has been removed from the mop head. Allow mop to drip dry away from walls and other objects. Laundering is not necessary. Wash out thoroughly clean all other objects and equipment that may have come in contact with the coating to ensure it is ready for use at the next opportunity.